

6. Replace and tighten visor clip to secure the visor bracket to your vehicle. *(Passenger's side shown)*

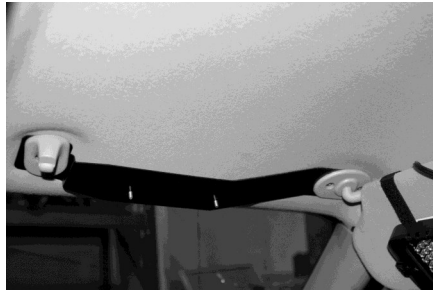

7. Tighten the screws on the visor arm to hold the visor bracket and light in place. *(Passenger's side shown)*



8. Install the angled "L" bracket over the two studs on the visor bracket as shown to the left. Secure it using two #8 washers and two acorn nuts. *Note: You may want to leave the acorn nuts slightly loose to allow for easier final adjustments. (Passenger's side shown).*

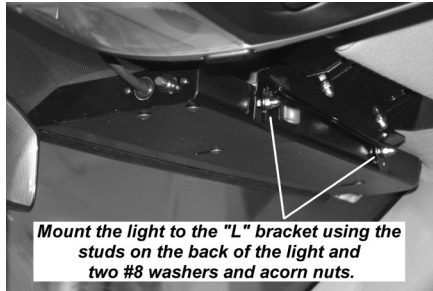

**Mount the light to the "L" bracket using the studs on the back of the light and two #8 washers and acorn nuts.**

9. Attach the light to the "L" bracket using the two stud brackets. Secure the light using two #8 washers and acorn nuts as shown to the left. *Note: You may want to leave the acorn nuts slightly loose to allow for easier final adjustments.*

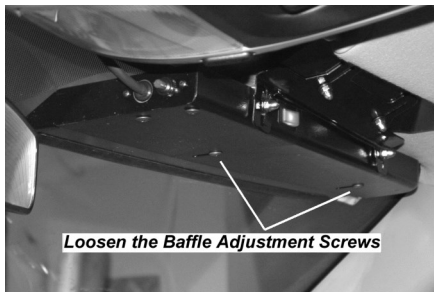

**Loosen the Baffle Adjustment Screws**

10. Loosen the two Baffle Adjustment Screws located on the bottom of the light to allow the baffle to slide. *(Passenger's side shown)*

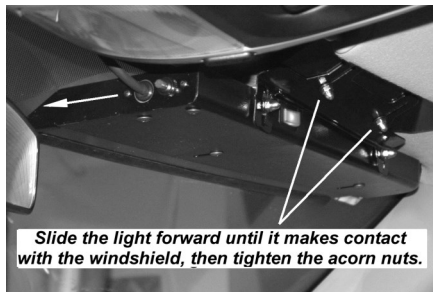

**Slide the light forward until it makes contact with the windshield, then tighten the acorn nuts.**

11. With the acorn nuts still slightly loose, slide the light as close to the front windshield as possible. Once it is touching the window, tighten the two acorn nuts that secure the two brackets together.

12. Repeat installation for the opposite side of the vehicle (Split Phantom only).

## Half and Split Phantom Mounting

### Back Mounted Vehicle-Specific Brackets

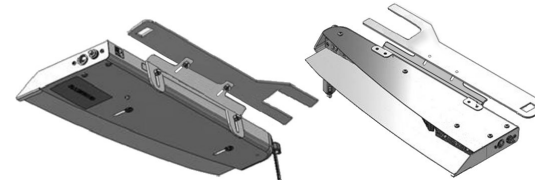

We have designed a number of brackets that fit specific vehicles. This instruction sheet applies to those that mount to the rear of your Half or Split Phantom.

Please Note: Some models utilize a single piece Back Mounted bracket (pictured to the right). If you have this version, skip Step 1 and use the enclosed screws to attach the bracket to the back of the light at Step 9.

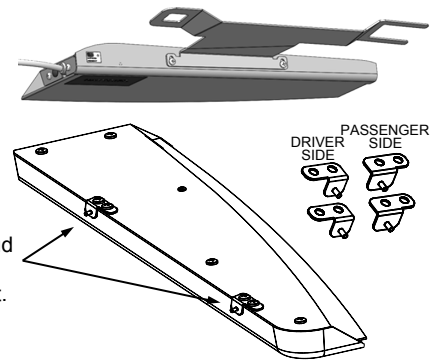

1. Remove the two pairs of screws from each light half and install the enclosed stud brackets at each location using the same screws you removed. The tabs on each stud bracket should point AWAY from the cable joining the two halves, as shown to the right.

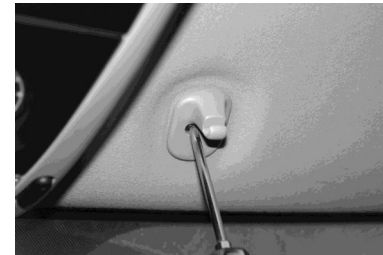

2. If mounting the Split Phantom, remove both the driver and passenger visor clips from the vehicle. Only the passenger side is necessary for the Half Phantom.

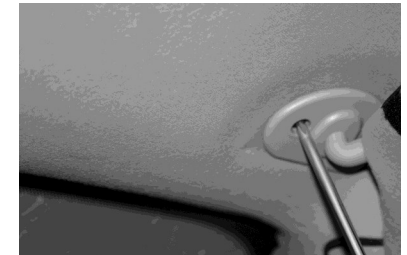

3. Loosen (**LOOSEN, DO NOT REMOVE!!**) the three visor pivot arm screws on one side of the vehicle with appropriate screwdriver. *(Passenger's side shown)*

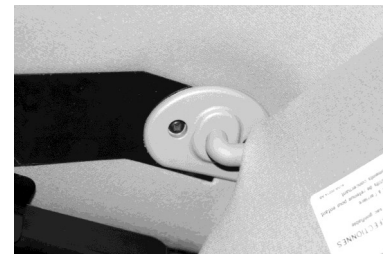

4. Slide the forked end of the visor bracket under the visor pivot arm that you just loosened. *(Passenger's side shown)*

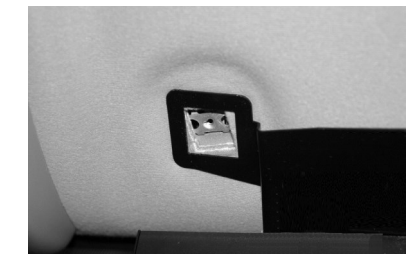

5. Align the square hole on the other end of the visor bracket with the visor clip hole. *(Passenger's side shown)*



6. Replace and tighten visor clip to secure the visor bracket to your vehicle. *(Passenger's side shown)*

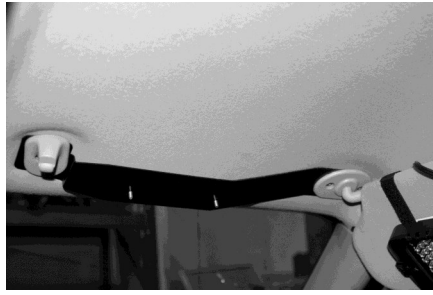

7. Tighten the screws on the visor arm to hold the visor bracket and light in place. *(Passenger's side shown)*



8. Install the angled "L" bracket over the two studs on the visor bracket as shown to the left. Secure it using two #8 washers and two acorn nuts. *Note: You may want to leave the acorn nuts slightly loose to allow for easier final adjustments. (Passenger's side shown).*

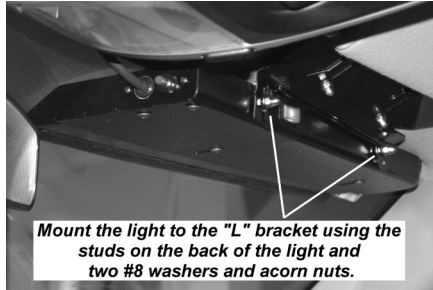

**Mount the light to the "L" bracket using the studs on the back of the light and two #8 washers and acorn nuts.**

9. Attach the light to the "L" bracket using the two stud brackets. Secure the light using two #8 washers and acorn nuts as shown to the left. *Note: You may want to leave the acorn nuts slightly loose to allow for easier final adjustments.*

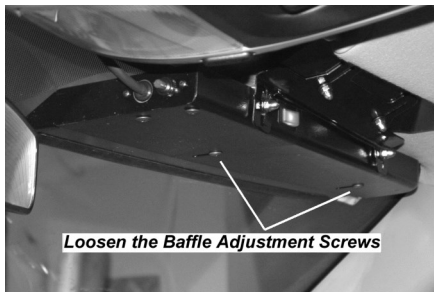

**Loosen the Baffle Adjustment Screws**

10. Loosen the two Baffle Adjustment Screws located on the bottom of the light to allow the baffle to slide. *(Passenger's side shown)*

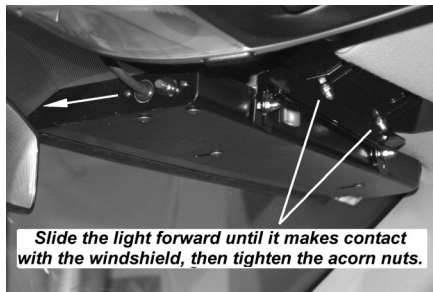

**Slide the light forward until it makes contact with the windshield, then tighten the acorn nuts.**

11. With the acorn nuts still slightly loose, slide the light as close to the front windshield as possible. Once it is touching the window, tighten the two acorn nuts that secure the two brackets together.

12. Repeat installation for the opposite side of the vehicle (Split Phantom only).

## Half and Split Phantom Mounting

### Back Mounted Vehicle-Specific Brackets

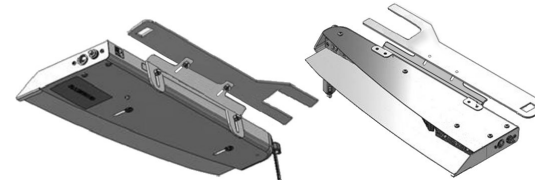

We have designed a number of brackets that fit specific vehicles. This instruction sheet applies to those that mount to the rear of your Half or Split Phantom.

Please Note: Some models utilize a single piece Back Mounted bracket (pictured to the right). If you have this version, skip Step 1 and use the enclosed screws to attach the bracket to the back of the light at Step 9.

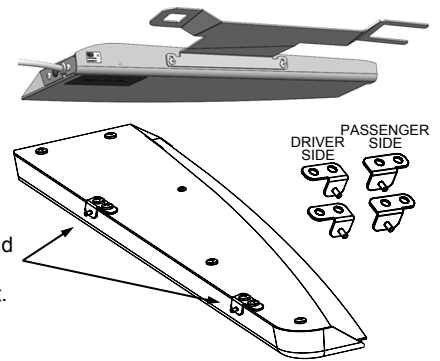

1. Remove the two pairs of screws from each light half and install the enclosed stud brackets at each location using the same screws you removed. The tabs on each stud bracket should point AWAY from the cable joining the two halves, as shown to the right.



2. If mounting the Split Phantom, remove both the driver and passenger visor clips from the vehicle. Only the passenger side is necessary for the Half Phantom.

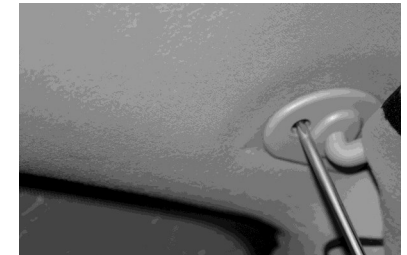

3. Loosen (**LOOSEN, DO NOT REMOVE!!**) the three visor pivot arm screws on one side of the vehicle with appropriate screwdriver. *(Passenger's side shown)*

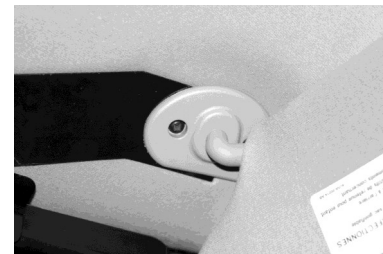

4. Slide the forked end of the visor bracket under the visor pivot arm that you just loosened. *(Passenger's side shown)*

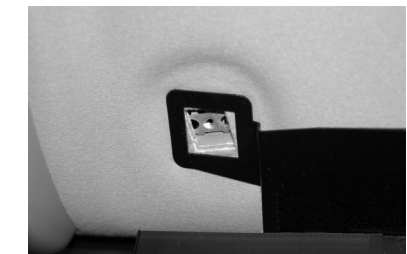

5. Align the square hole on the other end of the visor bracket with the visor clip hole. *(Passenger's side shown)*